

## GTX-17 Technical Specifications

### Video Production

**Grass Valley HD Kayenne Elite K-Frame Switcher**  
128 Inputs / 64 Outputs / 9 Mix Effects  
(6) Downstream Keyers per M/E  
FlexiKey Programmable Clean Feed  
12 iDPM / 4 eDPM / 4 Chroma Keys per Full M/E  
DoubleTake  
**Grass Valley K2 Summit 4-Channel Clip Store**  
**Evertz 496x980 HD Router**  
**32 GB Still Store**  
KSP 1 M/E Soft Panel GUI  
(1) **EVS XT3 Spot Box w/ Interface & Lance Controller**

### Record/Replay

(4) **12 Channel 4K EVS** (2 w/ SSMO Option)  
(2) **DNF Slow Motion Controllers**  
(2) **EVS X-File 3 Archive Station**  
(1) **EVS Sports Net3 Hub**  
(1) **CISCO 10 Gig Router**  
(1) **Panasonic AJ-HD1700 DVCPPro**  
(1) **Sony DVW-M2000 Digital Betacam**  
(4) **DVD SD Recorder/Players**  
*\*Upon Request EVS IP Director Package*

### Graphics

**Chyron HyperX3 w/ Keyboard**

### Cameras & Accessories

(12) **Sony HDC 2500 Multi-Format Camera**  
**4 Point Star Filters, Fixed or Variable Speed Shutter (1/60 to 1/2000)**  
(8) **Sony HDLA Lens Adapter**  
(8) **Vinten VECTOR 750 Panhead & Heavy Duty Tripods**  
(3) **Vinten Dolly Wheels for Hard Cameras**  
(4) **Sachtler Lightweight Tripod**  
(3) **Studio Build-Up Kits for Handheld Cameras**  
(8) **Fujinon 99x8.4 Studio/Field w/ Stabilization**  
(3) **Fujinon 23x7.6 ENG/EFP Handheld lens**  
(2) **Fujinon 18x5.5 ENG/EFP Wide Angle Lenses**  
*Mobile Unit Wired For 24 Cameras*

### Microphones/Speakers

(7) **Sennheiser MKH 416-P48 10" Shotgun Mics**  
(1) **Sennheiser MKE 44-P Stereo Mic**  
(5) **Sennheiser MD 46 Mics**  
(5) **Sennheiser MKH 70 Mics**  
(4) **Sony ECM 77B Lavalier Mics**  
(4) **Sony ME 67 Mics**

*\*Upon Request*

*Closed Captioning Device  
Telestrator*

### Production Monitor Wall

**Evertz VIP Routing & Multi-Image Display**  
(18) **32" HD LCD Monitors 16:9**

### External Monitors/Converters

(3) **12" HD LCD Field Monitors 16:9**  
(8) **18" HD LCD Field Monitors 16:9**  
(10) **Rattlers - ST Fiber to HD/SDI**  
(7) **HD/SDI to HDMI Converter**

### System/Routers

**Evertz Master Timecode Generator**  
**Evertz Changeover**  
**Evertz Digital Time Displays**  
**Evertz Magnum Control System**  
**Evertz 384X480 Stereo Router**  
288x288 AES Audio  
96x192 Analog Audio  
**Evertz 16x16 MADI**  
(1) **ForA 5-Channel HD Color Correctors/Frame Sync**  
(5) **AJA FS2 Frame Synchronizer/Converter**  
(8) **Evertz 7814 Dual Path Frame Sync**  
(96) **Evertz DA's**  
(24) **Evertz Audio Distribution**  
(10) **Evertz Dual AES DA**  
(1) **DSS Receiver**  
**QAM Digital Demodulator**  
(2) **Evertz 16-Channel Embedders**

**F&F PRODUCTIONS, LLC**

14333 Myerlake Circle | Clearwater, FL 33760 | (727) 530-5000 | info@fandfhd.tv

# GTX-17 Technical Specifications

## Intercom/Communications

- RTS Adam 160x160 Matrix
- (16) RTS KP 32 Keypanel
- (7) RTS KP 12 Keypanel
- (16) IFB Channels
- (16) RTS 4030 IFB Beltpack
- (25) RTS BP-325 Dual Channel Programmable Beltpack
- (4) RTS TIF 2000 Digital Telephone Interface
- (1) Phone System (12 Lines)
- (3) QKT
- (4) Ringdown Circuits
- (6) Motorola 2-Way Radios w/ 2 Base Stations
- (10) Single Muff Headsets
- (14) Double Muff Headsets
- (20) Lightweight Headsets
- (6) Sennheiser HMD-25 Announcer Headsets
- (6) Daltech Talkback Boxes
- (2) RTS Telex SPK 300

## Fiber Booth Kit

- Calrec Hydra
- 32x32 Audio
- 4x10 HD/SDI
- (2) KP Ports
- (2) 10/100/1G-LAN
- OR Router Controls

## Lighting

- (2) Lowell Light Kits w/ 4 Instruments each

## Audio

- Calrec Artemis Beam Digital Console V8 w/High Density Blue Fin2
- (64) Multi-layer faders w/Hydra2 Networking
- LCD Bar Graph and VU Metering
- (4) MADI Interface - 2-Streams
- 128x128 AES Audio
- 128x128 Analog Audio
- Dual Processor Engines
- Evertz EMX Audio Router
- 192x192 AES Audio
- 48x96 Analog Audio
- 20x21 MADI I/O
- Yamaha SPX2000 Multi-Effects Processor
- (2) Rane Audio Delays
- (3) dbx 166 XL Compressors
- (2) dbx 1046 Quad Compressors
- (2) 360 Systems Digicart/E Ethernet Audio Recorders w/ Zip Drive & SD Card
- ENCO EDAD Digital Audio Server
- (1) CD Player
- (1) DTS Neural Loudness Meter
- (2) DTS Neural Upmix Decoders
- (2) DTS Neural Downmix Encoders
- (2) DTS Neural Mono to Stereo 4-Channel Synthesizers
- Genelec 5.1 Surround Sound Monitoring
- DK Stereo Surround Audio Display
- RTW Stereo Surround Audio Display
- (20) Embedders / De-embedders

\*Upon Request 96 Channel Hydra Stage Box

## Cable

- 6500' Triax (Additional Upon Request)
- 3500' DT 12 Audio Mults
- 2000' Coax Video (Various Lengths)
- 1500' Single Audio (Various Lengths)
- 5-Pair Coax Mults (Various Lengths)
- 10-Pair Coax Mults (Various Lengths)
- 2250' SMPTE
- 5000' TAC 12 (Various Lengths)

## Power Requirements

- 3-Phase, 208 Volt, 400 Amps
- 200 Amp Environmental, 200 Amp Technical
- Maximum Distance From Power Panel: 150'

## A-Unit Dimensions (Expanded)

- W/ Tractor: 74' L x 13'6" H x 16' W
- W/O Tractor: 56' L x 13'6" H x 16' W
- Working Footprint: +5' Around
- Expands: Curb Side and Street Side

## B-Unit Dimensions

- W/ Tractor: 71' L x 13'6" H x 8'6" W
- W/O Tractor: 55' L x 13'6" H x 8'6" W
- Working Footprint: +5' Around

*\*Equipment on this specs sheet is subject to change without notice*

**F&F PRODUCTIONS, LLC**

14333 Myerlake Circle | Clearwater, FL 33760 | (727) 530-5000 | info@fandfhd.tv

# GTX-17 Technical Specifications

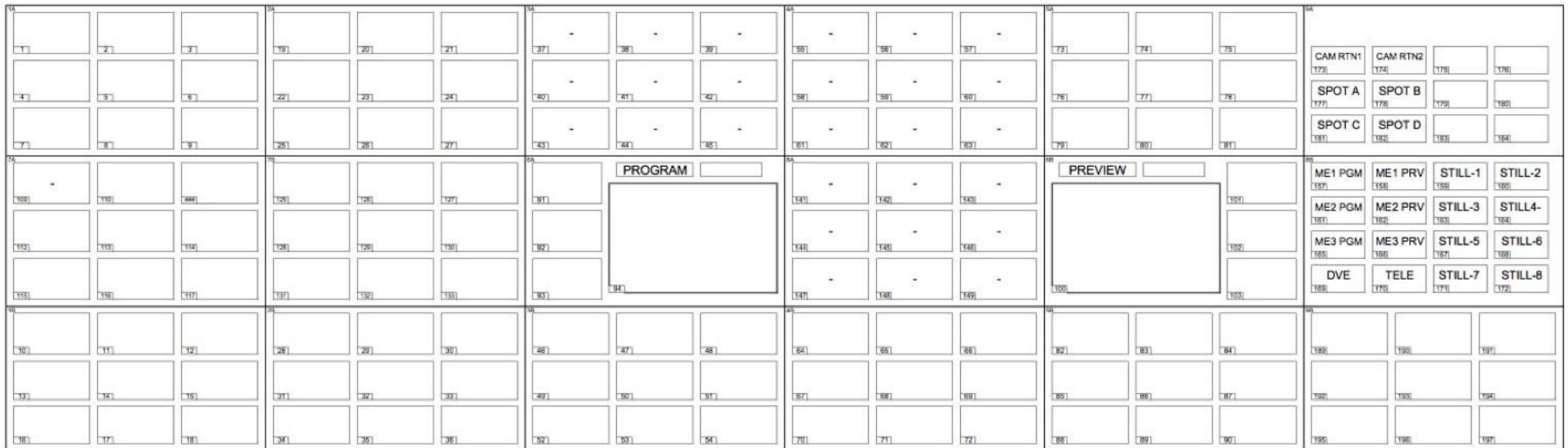

# GTX-17 Technical Specifications

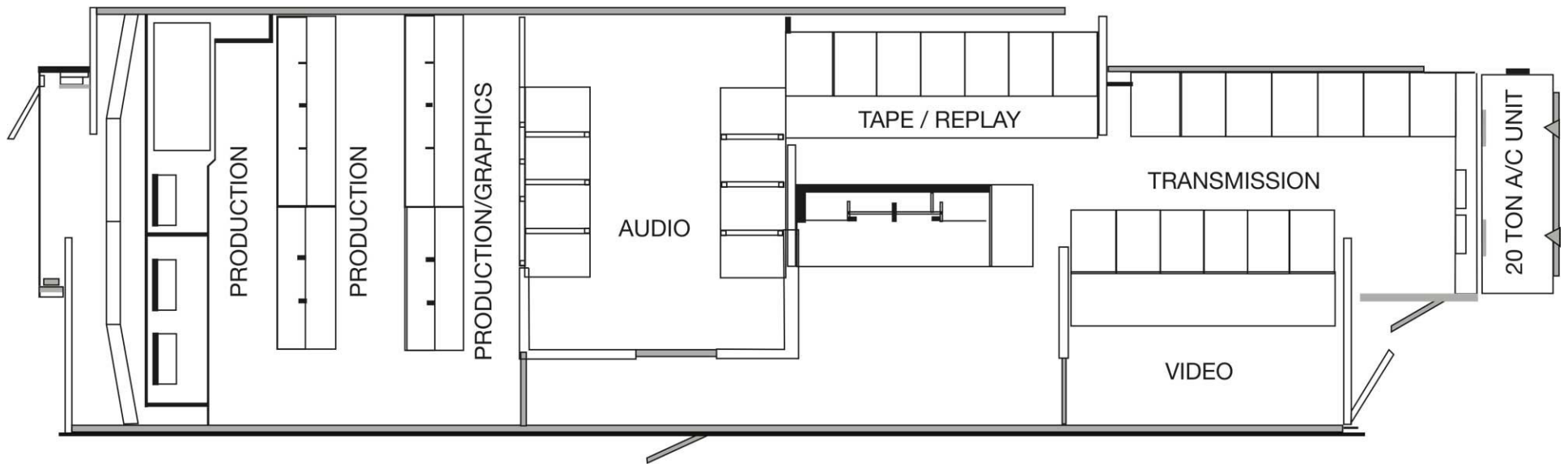

**F&F PRODUCTIONS, LLC**

14333 Myerlake Circle | Clearwater, FL 33760 | (727) 530-5000 | [info@fandfhd.tv](mailto:info@fandfhd.tv)

# GTX-17 Technical Specifications

B-17: Required with GTX-17

