

GTX-16 Technical Specifications

Video Production

Grass Valley HD Kayenne Elite K-Frame Switcher
128 Inputs / 64 Outputs / 9 Mix Effects
(6) Downstream Keyers per M/E
FlexiKey Programmable Clean Feed
12 iDPM / 4 eDPM / 4 Chroma Keys per Full M/E
DoubleTake
Grass Valley K2 Summit 4-Channel Clip Store
Evertz 288x576 EQX HD Router
32 GB Still Store
KSP 1 M/E Soft Panel GUI
(1) 6 Channel VIA SpotBox w/ Interface & Lance
Controller

Record/Replay

(3) EVS XT3 12-Channel LSM
(1) EVS XT3 8-Channel LSM (w/ SSMO Option)
(1) EVS X-File 3 Archive Station
(1) EVS Sports Net3 Hub
(1) CISCO 10 Gig Router
(1) EVS C-Cast Agent

**Upon Request EVS IP Director Package*

Graphics

**Upon Request*

Cameras & Accessories

(8) Sony HDC 2500 Multi-Format Camera
(2) Sony HDC 4300 Multi-Format Camera Fiber
Operation Only
(2) Sony HDC 1500R Multi-Format Camera
(6) Sony HDLA Lens Adapter
(12) HDFX/TX Triax to SMPTE Converters
(7) Vinten VECTOR 750 Panhead & Heavy Duty
Tripods
(3) Vinten Dolly Wheels for Hard Cameras
(3) Studio Build-Up Kits for Handheld Cameras
(5) Fujinon 101x8.9 Studio/Field w/stabilization
(2) Fujinon 88x8.8 Studio/Field w/stabilization
(2) Fujinon 22x7.6 ENG/EFP Handheld Lenses
(1) Fujinon 14X4.5 ENG/EFP Wide Angle Lenses
(3) Fujinon 13X4.5 ENG/EFP Wide Angle Lenses
(2) Fujinon 12X4.5 ENG/EFP Wide Angle Lenses
Mobile Unit Wired For 24 Cameras

Microphones/Speakers

(5) Sennheiser ME 67MP Shotgun Mics
(8) Sennheiser MKH 416-P48 10" Shotgun Mics
(1) Sennheiser MKE 44-P Stereo Mic
(8) Sennheiser MD 46 Mics
(3) Sennheiser MKH 70 Mics
(4) Electro-Voice 635A Stick Mics
(5) Sony ECM 77B Lavalier Mics

Production Monitor Wall

Evertz VIP Routing & Multi-Image Display
(14) 37" HD LCD Monitors 16:9

External Monitors/Converters

(4) 8" HD LCD Field Monitors 16:9
(8) 18.5" Ikegami ULE-185U HD/SDI Monitors
(6) Rattlers - ST Fiber to HD/SDI
(4) HD/SDI to HDMI Converter

System/Routers

Evertz Master Timecode Generator
Evertz Changeover
Evertz Magnum Control System
Evertz 2720x2976 EMR Router
192x144 AES Audio
48x96 Analog Audio
(1) Cobalt HD Color Corrector
(1) ForA 5-Channel HD Color Correctors/Frame
Sync
(5) AJA FS2 Frame Synchronizer/Converter
(10) Evertz 2012 Dual Path Frame Sync
(96) Evertz Cross Converters
(2) Evertz 16-Channel Embedders

**Equipment on this specs sheet is subject to change
without notice*

F&F PRODUCTIONS, LLC

14333 Myerlake Circle | Clearwater, FL 33760 | (727) 530-5000 | info@fandfhd.tv

GTX-16 Technical Specifications

Intercom/Communications

- RTS Adam 128x128 Matrix
- (16) RTS KP 32 Keypanel
- (7) RTS KP 12 Keypanel
- (16) IFB Channels
- (28) RTS BP-325 Dual Channel Programmable Beltpack
- (12) RTS 4030 IFB Beltpack
- (4) RTS TIF 2000 Digital Telephone Interface
- (1) Phone System (12 Lines)
- (3) QKT
- (4) Ringdown Circuits
- (6) Motorola 2-Way Radios w/ 2 Base Stations
- (20) Single Muff Headsets
- (14) Double Muff Headsets
- (20) Lightweight Headsets
- (3) Sennheiser HMD-25 Announcer Headsets
- (3) Sennheiser HMD-26 Announcer Headsets
- (6) Daltech Talkback Boxes
- (2) RTS Telex SPK 300

Fiber Booth Kit

- Telecast Adder II
- (64) Configurable Audio Channels
- (4) Data Channels (Bi-directional 10 x 10)
- Telecast Python II
- (8) HD/SDI

Audio

- Calrec Artemis Beam Digital Console V8 w/High Density Blue Fin2
- (64) Faders w/ Hydra2
- LCD Bar Graph and VU Metering
- MADI Interface – 2-Streams
- 128x128 AES Audio
- 128x128 Analog Audio
- (16) Evertz Dual AES Audio DA
- (30) Evertz Analog Audio DA
- Dual Processor Engines
- Yamaha SPX2000 Multi-Effects Processor
- (2) Rane Audio Delays
- (3) dbx 166 XL Compressors
- (2) dbx 1046 Quad Compressors
- (1) 360 Systems DigiCart E w/ GPI (1 w/ SD Card Reader)
- (1) 360 Systems DigiCart II w/ ZipDrives
- ENCO EDAD Digital Audio Server
- (1) CD Player
- (1) DTS Neural Loudness Meter
- (2) DTS Neural Upmix Decoders
- (2) DTS Neural Downmix Encoders
- (1) DTS Neural Mono to Stereo 4-Channel Synthesizers
- Genelec 5.1 Surround Sound Monitoring
- RTW Stereo Surround Audio Display
- *Upon Request 96 Channel Hydra Stage Box*

Lighting

- (1) ARRI Light Kit w/ 4 Instruments

Cable

- 5000' Tac-12 (Various Lengths)
- 9500' SMPTE (Various Lengths)
- 5000' Triax (Additional Upon Request)
- 3300' DT 12 Audio Mults
- 2000' Coax Video (Various Lengths)
- 1500' Single Audio (Various Lengths)
- 5-Pair Coax Mults (Various Lengths)
- 10-Pair Coax Mults (Various Lengths)

Power Requirements

- 3-Phase
- 208 Volt
- 400 Amps
- 200 Amp Environmental
- 200 Amp Technical
- Maximum Distance From Power Panel: 150'

A-Unit Dimensions (Expanded)

- W/ Tractor: 74' L x 13'6" H x 16' W
- W/O Tractor: 56' L x 13'6" H x 16' W
- Working Footprint: +5' Around
- Expands: Curb Side and Street Side

B-Unit Dimensions

- W/ Tractor: 71' L x 13'6" H x 8'6" W
- W/O Tractor: 55' L x 13'6" H x 8'6" W
- Working Footprint: +5' Around

**Equipment on this specs sheet is subject to change without notice*

F&F PRODUCTIONS, LLC

14333 Myerlake Circle | Clearwater, FL 33760 | (727) 530-5000 | info@fandfhd.tv

GTX-16 Technical Specifications



GTX-16 Technical Specifications

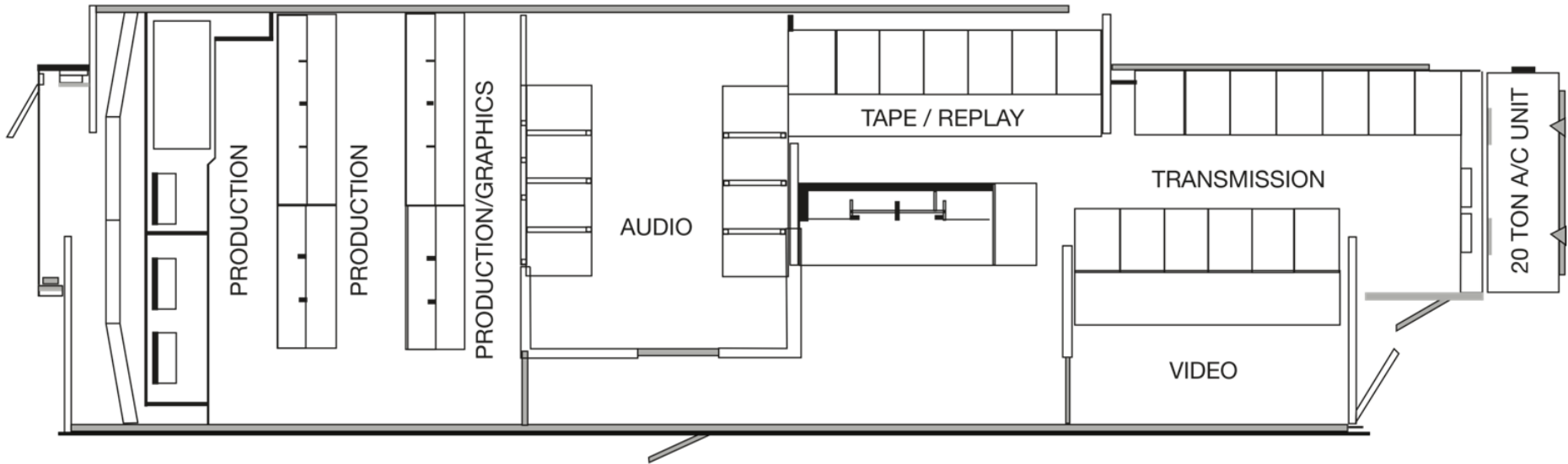

F&F PRODUCTIONS, LLC

14333 Myerlake Circle | Clearwater, FL 33760 | (727) 530-5000 | info@fandfhd.tv

GTX-16 Technical Specifications

B-16: Required with GTX-16

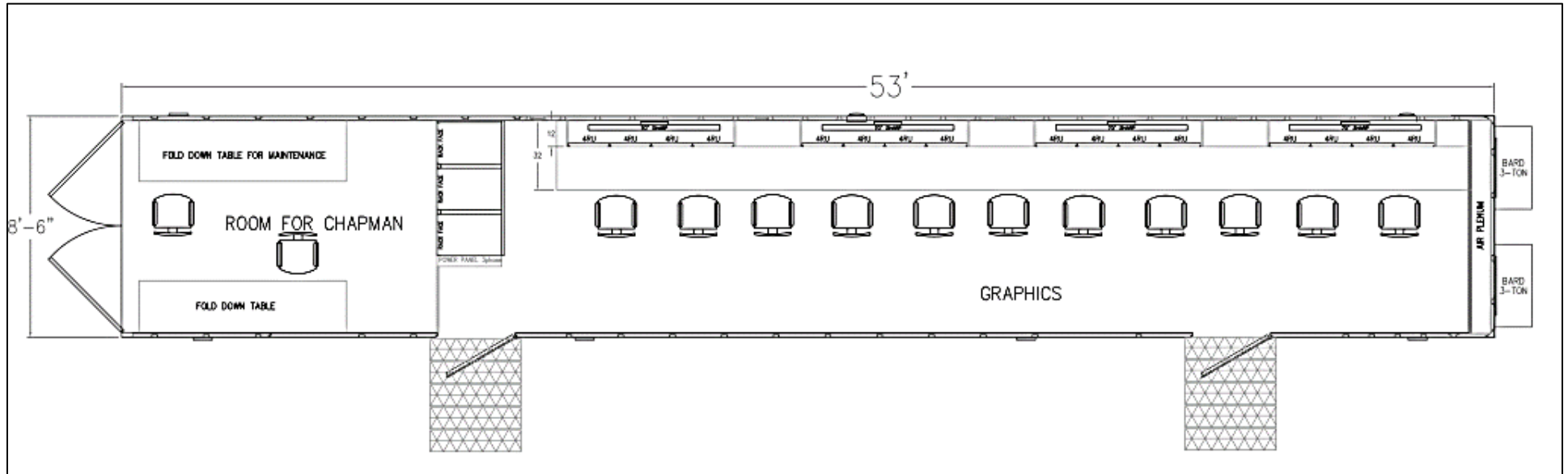

F&F PRODUCTIONS, LLC

14333 Myerlake Circle | Clearwater, FL 33760 | (727) 530-5000 | info@fandfhd.tv