

GTX-17 Technical Specifications

Video Production

Grass Valley HD Kayenne Elite K-Frame Switcher
128 Inputs / 64 Outputs / 9 Mix Effects
(6) Downstream Keyers per M/E
FlexiKey Programmable Clean Feed
12 iDPM / 4 eDPM / 4 Chroma Keys per Full M/E
DoubleTake
Grass Valley K2 Summit 4-Channel Clip Store
Evertz 496x980 HD Router
32 GB Still Store
KSP 1 M/E Soft Panel GUI
(1) **EVS XT3 Spot Box w/ Interface & Lance Controller**

Record/Replay

(4) **12 Channel 4K EVS** (2 w/ SSMO Option)
(2) **DNF Slow Motion Controllers**
(2) **EVS X-File 3 Archive Station**
(1) **EVS Sports Net3 Hub**
(1) **CISCO 10 Gig Router**
(1) **Panasonic AJ-HD1700 DVCPPro**
(1) **Sony DVW-M2000 Digital Betacam**
(4) **DVD SD Recorder/Players**
**Upon Request EVS IP Director Package*

Graphics

Chyron HyperX3 w/ Keyboard

Cameras & Accessories

(12) **Sony HDC 2500 Multi-Format Camera**
4 Point Star Filters, Fixed or Variable Speed Shutter (1/60 to 1/2000)
(8) **Sony HDLA Lens Adapter**
(8) **Vinten VECTOR 750 Panhead & Heavy Duty Tripods**
(3) **Vinten Dolly Wheels for Hard Cameras**
(4) **Sachtler Lightweight Tripod**
(3) **Studio Build-Up Kits for Handheld Cameras**
(8) **Fujinon 99x8.4 Studio/Field w/ Stabilization**
(3) **Fujinon 23x7.6 ENG/EFP Handheld lens**
(2) **Fujinon 18x5.5 ENG/EFP Wide Angle Lenses**
Mobile Unit Wired For 24 Cameras

Microphones/Speakers

(7) **Sennheiser MKH 416-P48 10" Shotgun Mics**
(1) **Sennheiser MKE 44-P Stereo Mic**
(5) **Sennheiser MD 46 Mics**
(5) **Sennheiser MKH 70 Mics**
(4) **Sony ECM 77B Lavalier Mics**
(4) **Sony ME 67 Mics**

**Upon Request*

*Closed Captioning Device
Telestrator*

Production Monitor Wall

Evertz VIP Routing & Multi-Image Display
(18) **32" HD LCD Monitors 16:9**

External Monitors/Converters

(3) **12" HD LCD Field Monitors 16:9**
(8) **18" HD LCD Field Monitors 16:9**
(10) **Rattlers - ST Fiber to HD/SDI**
(7) **HD/SDI to HDMI Converter**

System/Routers

Evertz Master Timecode Generator
Evertz Changeover
Evertz Digital Time Displays
Evertz Magnum Control System
Evertz 384X480 Stereo Router
288x288 AES Audio
96x192 Analog Audio
Evertz 16x16 MADI
(1) **ForA 5-Channel HD Color Correctors/Frame Sync**
(5) **AJA FS2 Frame Synchronizer/Converter**
(8) **Evertz 7814 Dual Path Frame Sync**
(96) **Evertz DA's**
(24) **Evertz Audio Distribution**
(10) **Evertz Dual AES DA**
(1) **DSS Receiver**
QAM Digital Demodulator
(2) **Evertz 16-Channel Embedders**

F&F PRODUCTIONS, LLC

14333 Myerlake Circle | Clearwater, FL 33760 | (727) 530-5000 | info@fandfhd.tv

GTX-17 Technical Specifications

Intercom/Communications

- RTS Adam 160x160 Matrix
- (16) RTS KP 32 Keypanel
- (7) RTS KP 12 Keypanel
- (16) IFB Channels
- (16) RTS 4030 IFB Beltpack
- (25) RTS BP-325 Dual Channel Programmable Beltpack
- (4) RTS TIF 2000 Digital Telephone Interface
- (1) Phone System (12 Lines)
- (3) QKT
- (4) Ringdown Circuits
- (6) Motorola 2-Way Radios w/ 2 Base Stations
- (10) Single Muff Headsets
- (14) Double Muff Headsets
- (20) Lightweight Headsets
- (6) Sennheiser HMD-25 Announcer Headsets
- (6) Daltech Talkback Boxes
- (2) RTS Telex SPK 300

Fiber Booth Kit

- Calrec Hydra
- 32x32 Audio
- 4x10 HD/SDI
- (2) KP Ports
- (2) 10/100/1G-LAN
- OR Router Controls

Lighting

- (2) Lowell Light Kits w/ 4 Instruments each

Audio

- Calrec Artemis Beam Digital Console V8 w/High Density Blue Fin2
- (64) Multi-layer faders w/Hydra2 Networking
- LCD Bar Graph and VU Metering
- (4) MADI Interface - 2-Streams
- 128x128 AES Audio
- 128x128 Analog Audio
- Dual Processor Engines
- Evertz EMX Audio Router
- 192x192 AES Audio
- 48x96 Analog Audio
- 20x21 MADI I/O
- Yamaha SPX2000 Multi-Effects Processor
- (2) Rane Audio Delays
- (3) dbx 166 XL Compressors
- (2) dbx 1046 Quad Compressors
- (2) 360 Systems Digicart/E Ethernet Audio Recorders w/ Zip Drive & SD Card
- ENCO EDAD Digital Audio Server
- (1) CD Player
- (1) DTS Neural Loudness Meter
- (2) DTS Neural Upmix Decoders
- (2) DTS Neural Downmix Encoders
- (2) DTS Neural Mono to Stereo 4-Channel Synthesizers
- Genelec 5.1 Surround Sound Monitoring
- DK Stereo Surround Audio Display
- RTW Stereo Surround Audio Display
- (20) Embedders / De-embedders

*Upon Request 96 Channel Hydra Stage Box

Cable

- 6500' Triax (Additional Upon Request)
- 3500' DT 12 Audio Mults
- 2000' Coax Video (Various Lengths)
- 1500' Single Audio (Various Lengths)
- 5-Pair Coax Mults (Various Lengths)
- 10-Pair Coax Mults (Various Lengths)
- 2250' SMPTE
- 5000' TAC 12 (Various Lengths)

Power Requirements

- 3-Phase, 208 Volt, 400 Amps
- 200 Amp Environmental, 200 Amp Technical
- Maximum Distance From Power Panel: 150'

A-Unit Dimensions (Expanded)

- W/ Tractor: 74' L x 13'6" H x 16' W
- W/O Tractor: 56' L x 13'6" H x 16' W
- Working Footprint: +5' Around
- Expands: Curb Side and Street Side

B-Unit Dimensions

- W/ Tractor: 71' L x 13'6" H x 8'6" W
- W/O Tractor: 55' L x 13'6" H x 8'6" W
- Working Footprint: +5' Around

**Equipment on this specs sheet is subject to change without notice*

F&F PRODUCTIONS, LLC

14333 Myerlake Circle | Clearwater, FL 33760 | (727) 530-5000 | info@fandfhd.tv

GTX-17 Technical Specifications

<table border="1" style="width: 100%; height: 100%; border-collapse: collapse;"> <tr><td>1</td><td>2</td><td>3</td></tr> <tr><td>4</td><td>5</td><td>6</td></tr> <tr><td>7</td><td>8</td><td>9</td></tr> </table>	1	2	3	4	5	6	7	8	9	<table border="1" style="width: 100%; height: 100%; border-collapse: collapse;"> <tr><td>19</td><td>20</td><td>21</td></tr> <tr><td>22</td><td>23</td><td>24</td></tr> <tr><td>25</td><td>26</td><td>27</td></tr> </table>	19	20	21	22	23	24	25	26	27	<table border="1" style="width: 100%; height: 100%; border-collapse: collapse;"> <tr><td>37</td><td>38</td><td>39</td></tr> <tr><td>40</td><td>41</td><td>42</td></tr> <tr><td>43</td><td>44</td><td>45</td></tr> </table>	37	38	39	40	41	42	43	44	45	<table border="1" style="width: 100%; height: 100%; border-collapse: collapse;"> <tr><td>56</td><td>58</td><td>57</td></tr> <tr><td>58</td><td>59</td><td>60</td></tr> <tr><td>61</td><td>62</td><td>63</td></tr> </table>	56	58	57	58	59	60	61	62	63	<table border="1" style="width: 100%; height: 100%; border-collapse: collapse;"> <tr><td>73</td><td>74</td><td>75</td></tr> <tr><td>76</td><td>77</td><td>78</td></tr> <tr><td>79</td><td>80</td><td>81</td></tr> </table>	73	74	75	76	77	78	79	80	81	<table border="1" style="width: 100%; height: 100%; border-collapse: collapse;"> <tr> <td>CAM RTN1 172</td> <td>CAM RTN2 174</td> <td>175</td> <td>176</td> </tr> <tr> <td>SPOT A 177</td> <td>SPOT B 178</td> <td>179</td> <td>180</td> </tr> <tr> <td>SPOT C 181</td> <td>SPOT D 182</td> <td>183</td> <td>184</td> </tr> </table>	CAM RTN1 172	CAM RTN2 174	175	176	SPOT A 177	SPOT B 178	179	180	SPOT C 181	SPOT D 182	183	184
1	2	3																																																												
4	5	6																																																												
7	8	9																																																												
19	20	21																																																												
22	23	24																																																												
25	26	27																																																												
37	38	39																																																												
40	41	42																																																												
43	44	45																																																												
56	58	57																																																												
58	59	60																																																												
61	62	63																																																												
73	74	75																																																												
76	77	78																																																												
79	80	81																																																												
CAM RTN1 172	CAM RTN2 174	175	176																																																											
SPOT A 177	SPOT B 178	179	180																																																											
SPOT C 181	SPOT D 182	183	184																																																											
<table border="1" style="width: 100%; height: 100%; border-collapse: collapse;"> <tr><td>100</td><td>101</td><td>102</td></tr> <tr><td>103</td><td>104</td><td>105</td></tr> <tr><td>106</td><td>107</td><td>108</td></tr> </table>	100	101	102	103	104	105	106	107	108	<table border="1" style="width: 100%; height: 100%; border-collapse: collapse;"> <tr><td>126</td><td>127</td><td>128</td></tr> <tr><td>129</td><td>130</td><td>131</td></tr> <tr><td>132</td><td>133</td><td>134</td></tr> </table>	126	127	128	129	130	131	132	133	134	<table border="1" style="width: 100%; height: 100%; border-collapse: collapse;"> <tr> <td style="width: 60%;"></td> <td style="width: 40%; text-align: left;">PROGRAM</td> </tr> <tr> <td colspan="2" style="height: 40px;"></td> </tr> <tr> <td>31</td> <td>34</td> </tr> </table>		PROGRAM			31	34	<table border="1" style="width: 100%; height: 100%; border-collapse: collapse;"> <tr><td>141</td><td>142</td><td>143</td></tr> <tr><td>144</td><td>145</td><td>146</td></tr> <tr><td>147</td><td>148</td><td>149</td></tr> </table>	141	142	143	144	145	146	147	148	149	<table border="1" style="width: 100%; height: 100%; border-collapse: collapse;"> <tr> <td style="width: 60%;"></td> <td style="width: 40%; text-align: left;">PREVIEW</td> </tr> <tr> <td colspan="2" style="height: 40px;"></td> </tr> <tr> <td>100</td> <td>103</td> </tr> </table>		PREVIEW			100	103	<table border="1" style="width: 100%; height: 100%; border-collapse: collapse;"> <tr> <td>ME1 PGM 187</td> <td>ME1 PRV 188</td> <td>STILL-1 189</td> <td>STILL-2 190</td> </tr> <tr> <td>ME2 PGM 191</td> <td>ME2 PRV 192</td> <td>STILL-3 193</td> <td>STILL-4 194</td> </tr> <tr> <td>ME3 PGM 195</td> <td>ME3 PRV 196</td> <td>STILL-5 197</td> <td>STILL-6 198</td> </tr> <tr> <td>DVE 199</td> <td>TELE 199</td> <td>STILL-7 199</td> <td>STILL-8 199</td> </tr> </table>	ME1 PGM 187	ME1 PRV 188	STILL-1 189	STILL-2 190	ME2 PGM 191	ME2 PRV 192	STILL-3 193	STILL-4 194	ME3 PGM 195	ME3 PRV 196	STILL-5 197	STILL-6 198	DVE 199	TELE 199	STILL-7 199	STILL-8 199		
100	101	102																																																												
103	104	105																																																												
106	107	108																																																												
126	127	128																																																												
129	130	131																																																												
132	133	134																																																												
	PROGRAM																																																													
31	34																																																													
141	142	143																																																												
144	145	146																																																												
147	148	149																																																												
	PREVIEW																																																													
100	103																																																													
ME1 PGM 187	ME1 PRV 188	STILL-1 189	STILL-2 190																																																											
ME2 PGM 191	ME2 PRV 192	STILL-3 193	STILL-4 194																																																											
ME3 PGM 195	ME3 PRV 196	STILL-5 197	STILL-6 198																																																											
DVE 199	TELE 199	STILL-7 199	STILL-8 199																																																											
<table border="1" style="width: 100%; height: 100%; border-collapse: collapse;"> <tr><td>110</td><td>111</td><td>112</td></tr> <tr><td>113</td><td>114</td><td>115</td></tr> <tr><td>116</td><td>117</td><td>118</td></tr> </table>	110	111	112	113	114	115	116	117	118	<table border="1" style="width: 100%; height: 100%; border-collapse: collapse;"> <tr><td>28</td><td>29</td><td>30</td></tr> <tr><td>31</td><td>32</td><td>33</td></tr> <tr><td>34</td><td>35</td><td>36</td></tr> </table>	28	29	30	31	32	33	34	35	36	<table border="1" style="width: 100%; height: 100%; border-collapse: collapse;"> <tr><td>46</td><td>47</td><td>48</td></tr> <tr><td>49</td><td>50</td><td>51</td></tr> <tr><td>52</td><td>53</td><td>54</td></tr> </table>	46	47	48	49	50	51	52	53	54	<table border="1" style="width: 100%; height: 100%; border-collapse: collapse;"> <tr><td>64</td><td>65</td><td>66</td></tr> <tr><td>67</td><td>68</td><td>69</td></tr> <tr><td>70</td><td>71</td><td>72</td></tr> </table>	64	65	66	67	68	69	70	71	72	<table border="1" style="width: 100%; height: 100%; border-collapse: collapse;"> <tr><td>82</td><td>83</td><td>84</td></tr> <tr><td>85</td><td>86</td><td>87</td></tr> <tr><td>88</td><td>89</td><td>90</td></tr> </table>	82	83	84	85	86	87	88	89	90	<table border="1" style="width: 100%; height: 100%; border-collapse: collapse;"> <tr><td>180</td><td>180</td><td>180</td></tr> <tr><td>180</td><td>180</td><td>180</td></tr> <tr><td>180</td><td>180</td><td>180</td></tr> </table>	180	180	180	180	180	180	180	180	180			
110	111	112																																																												
113	114	115																																																												
116	117	118																																																												
28	29	30																																																												
31	32	33																																																												
34	35	36																																																												
46	47	48																																																												
49	50	51																																																												
52	53	54																																																												
64	65	66																																																												
67	68	69																																																												
70	71	72																																																												
82	83	84																																																												
85	86	87																																																												
88	89	90																																																												
180	180	180																																																												
180	180	180																																																												
180	180	180																																																												

GTX-17 Technical Specifications

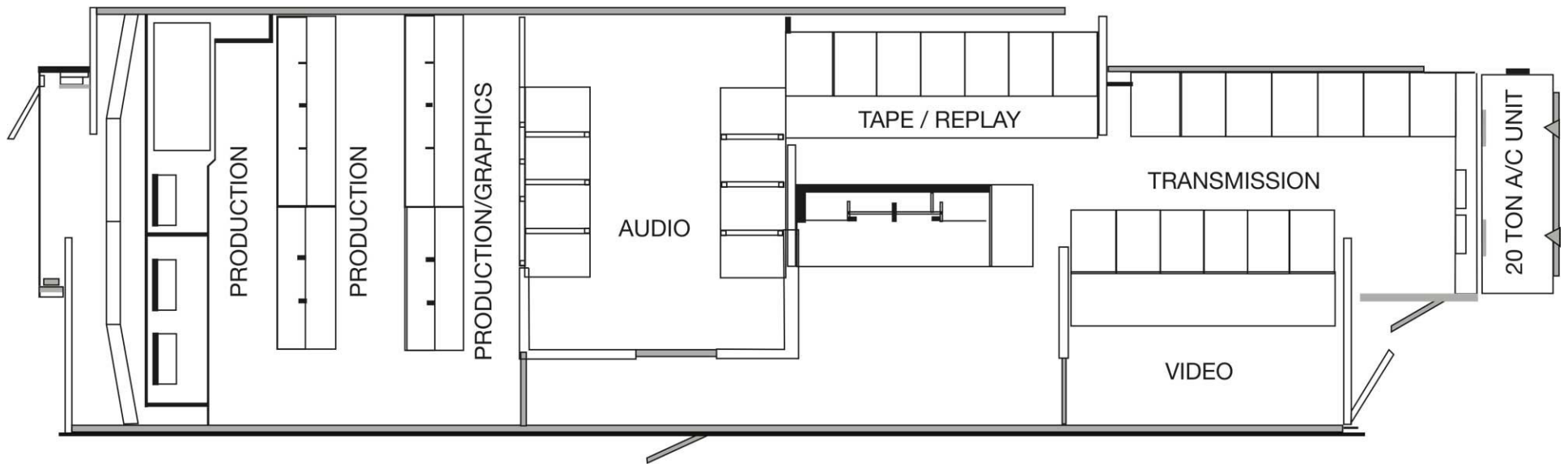

F&F PRODUCTIONS, LLC

14333 Myerlake Circle | Clearwater, FL 33760 | (727) 530-5000 | info@fandfhd.tv

GTX-17 Technical Specifications

B-17: Required with GTX-17

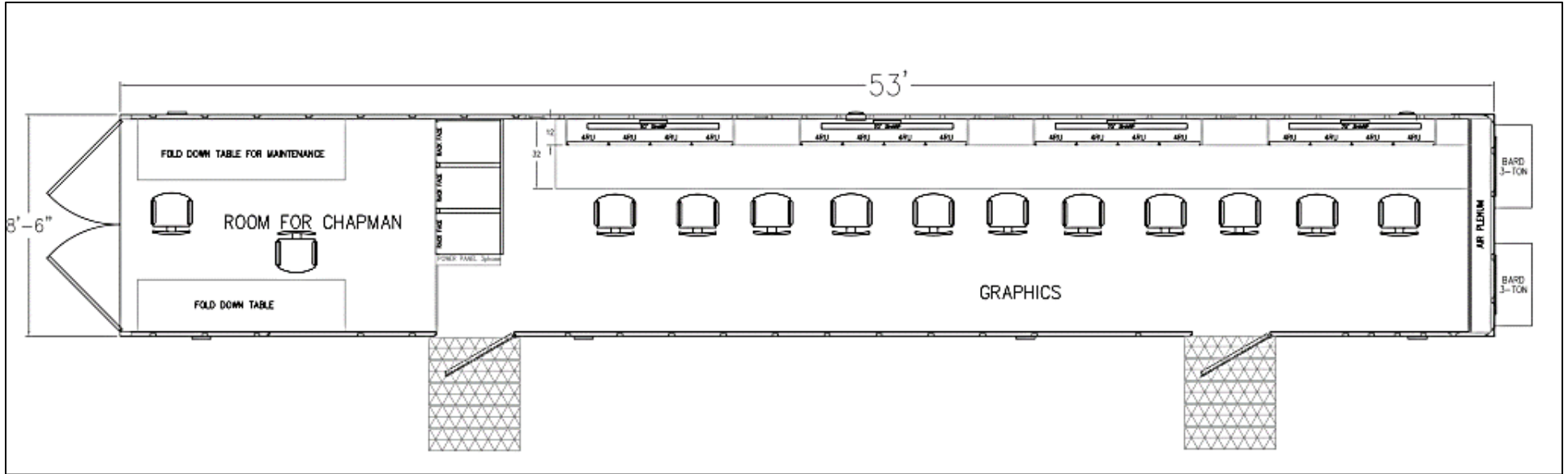

F&F PRODUCTIONS, LLC

14333 Myerlake Circle | Clearwater, FL 33760 | (727) 530-5000 | info@fandfhd.tv