

GTX-17 Technical Specifications

Video Production

Grass Valley HD Kayenne Elite K-Frame Switcher
128 Inputs / 64 Outputs / 9 Mix Effects
(6) Downstream Keyers per M/E
FlexiKey Programmable Clean Feed
12 iDPM / 4 eDPM / 4 Chroma Keys per Full M/E
DoubleTake
Grass Valley K2 Summit 4-Channel Clip Store
Evertz 496x980 HD Router
32 GB Still Store
KSP 1 M/E Soft Panel GUI
(1) **EVS XT3 Spot Box w/ Interface & Lance Controller**

Record/Replay

(4) **12 Channel 4K EVS** (2 w/ SSMO Option)
(2) **DNF Slow Motion Controllers**
(2) **EVS X-File 3 Archive Station**
(1) **EVS Sports Net3 Hub**
(1) **CISCO 10 Gig Router**
(1) **Panasonic AJ-HD1700 DVCPPro**
(1) **Sony DVW-M2000 Digital Betacam**
(4) **DVD SD Recorder/Players**
**Upon Request EVS IP Director Package*

Graphics

Chyron HyperX3 w/ Keyboard

Cameras & Accessories

(12) **Sony HDC 2500 Multi-Format Camera**
4 Point Star Filters, Fixed or Variable Speed Shutter (1/60 to 1/2000)
(8) **Sony HDLA Lens Adapter**
(8) **Vinten VECTOR 750 Panhead & Heavy Duty Tripods**
(3) **Vinten Dolly Wheels for Hard Cameras**
(4) **Sachtler Lightweight Tripod**
(3) **Studio Build-Up Kits for Handheld Cameras**
(8) **Fujinon 99x8.4 Studio/Field w/ Stabilization**
(3) **Fujinon 23x7.6 ENG/EFP Handheld lens**
(2) **Fujinon 18x5.5 ENG/EFP Wide Angle Lenses**
Mobile Unit Wired For 24 Cameras

Microphones/Speakers

(7) **Sennheiser MKH 416-P48 10" Shotgun Mics**
(1) **Sennheiser MKE 44-P Stereo Mic**
(5) **Sennheiser MD 46 Mics**
(5) **Sennheiser MKH 70 Mics**
(4) **Sony ECM 77B Lavalier Mics**
(4) **Sony ME 67 Mics**

**Upon Request*

Closed Captioning Device
Telestrator

Production Monitor Wall

Evertz VIP Routing & Multi-Image Display
(18) **32" HD LCD Monitors 16:9**

External Monitors/Converters

(3) **12" HD LCD Field Monitors 16:9**
(8) **18" HD LCD Field Monitors 16:9**
(10) **Rattlers - ST Fiber to HD/SDI**
(7) **HD/SDI to HDMI Converter**

System/Routers

Evertz Master Timecode Generator
Evertz Changeover
Evertz Digital Time Displays
Evertz Magnum Control System
Evertz 384X480 Stereo Router
288x288 AES Audio
96x192 Analog Audio
Evertz 16x16 MADI
(1) **ForA 5-Channel HD Color Correctors/Frame Sync**
(5) **AJA FS2 Frame Synchronizer/Converter**
(8) **Evertz 7814 Dual Path Frame Sync**
(96) **Evertz DA's**
(24) **Evertz Audio Distribution**
(10) **Evertz Dual AES DA**
(1) **DSS Receiver**
QAM Digital Demodulator
(2) **Evertz 16-Channel Embedders**

GTX-17 Technical Specifications

Intercom/Communications

- RTS Adam 160x160 Matrix
- (16) RTS KP 32 Keypanel
- (7) RTS KP 12 Keypanel
- (16) IFB Channels
- (16) RTS 4030 IFB Beltpack
- (25) RTS BP-325 Dual Channel Programmable Beltpack
- (4) RTS TIF 2000 Digital Telephone Interface
- (1) Phone System (12 Lines)
- (3) QKT
- (4) Ringdown Circuits
- (6) Motorola 2-Way Radios w/ 2 Base Stations
- (10) Single Muff Headsets
- (14) Double Muff Headsets
- (20) Lightweight Headsets
- (6) Sennheiser HMD-25 Announcer Headsets
- (6) Daltech Talkback Boxes
- (2) RTS Telex SPK 300

Fiber Booth Kit

- Calrec Hydra
- 32x32 Audio
- 4x10 HD/SDI
- (2) KP Ports
- (2) 10/100/1G-LAN
- OR Router Controls

Lighting

- (2) Lowell Light Kits w/ 4 Instruments each

Audio

- Calrec Artemis Beam Digital Console V8 w/High Density Blue Fin2
- (64) Multi-layer faders w/Hydra2 Networking
- LCD Bar Graph and VU Metering
- (4) MAD1 Interface - 2-Streams
- 128x128 AES Audio
- 128x128 Analog Audio
- Dual Processor Engines
- Evertz EMX Audio Router
- 192x192 AES Audio
- 48x96 Analog Audio
- 20x21 MAD1 I/O
- Yamaha SPX2000 Multi-Effects Processor
- (2) Rane Audio Delays
- (3) dbx 166 XL Compressors
- (2) dbx 1046 Quad Compressors
- (2) 360 Systems Digicart/E Ethernet Audio Recorders w/ Zip Drive & SD Card
- ENCO EDAD Digital Audio Server
- (1) CD Player
- (1) DTS Neural Loudness Meter
- (2) DTS Neural Upmix Decoders
- (2) DTS Neural Downmix Encoders
- (2) DTS Neural Mono to Stereo 4-Channel Synthesizers
- Genelec 5.1 Surround Sound Monitoring
- DK Stereo Surround Audio Display
- RTW Stereo Surround Audio Display
- (20) Embedders / De-embedders

*Upon Request 96 Channel Hydra Stage Box

Cable

- 6500' Triax (Additional Upon Request)
- 3500' DT 12 Audio Mults
- 2000' Coax Video (Various Lengths)
- 1500' Single Audio (Various Lengths)
- 5-Pair Coax Mults (Various Lengths)
- 10-Pair Coax Mults (Various Lengths)
- 2250' SMPTE
- 5000' TAC 12 (Various Lengths)

Power Requirements

- 3-Phase, 208 Volt, 400 Amps
- 200 Amp Environmental, 200 Amp Technical
- Maximum Distance From Power Panel: 150'

A-Unit Dimensions (Expanded)

- W/ Tractor: 74' L x 13'6" H x 16' W
- W/O Tractor: 56' L x 13'6" H x 16' W
- Working Footprint: +5' Around
- Expands: Curb Side

B-Unit Dimensions

- W/ Tractor: 71' L x 13'6" H x 8'6" W
- W/O Tractor: 55' L x 13'6" H x 8'6" W
- Working Footprint: +5' Around

**Equipment on this specs sheet is subject to change without notice*

F&F PRODUCTIONS, LLC

14333 Myerlake Circle | Clearwater, FL 33760 | (727) 530-5000 | info@fandfhd.tv

GTX-17 Technical Specifications

1A 1 2 3	19 20 21	37 38 39	55 56 57	73 74 75	CAM RTN1 173 174 175 176 177 178 179 180 181 182 183 184		
4 5 6	22 23 24	40 41 42	58 59 60	76 77 78			
7 8 9	25 26 27	43 44 45	61 62 63	79 80 81			
10 11 12 13	125 126 127	PROGRAM 191 192 193 194	131 132 133	PREVIEW 151 152 153 154 155	ME1 PGM 157 158 159 160 161 162 163 164 165 166 167 168 169 170 171 172 173 174 175 176 177 178 179 180 181 182 183 184 185 186 187 188 189 190 191 192 193 194 195 196 197 198 199 200 201 202 203 204 205 206 207 208 209 210 211 212 213 214 215 216 217 218 219 220 221 222 223 224 225 226 227 228 229 230 231 232 233 234 235 236 237 238 239 240 241 242 243 244 245 246 247 248 249 250 251 252 253 254 255 256 257 258 259 260 261 262 263 264 265 266 267 268 269 270 271 272 273 274 275 276 277 278 279 280 281 282 283 284 285 286 287 288 289 290 291 292 293 294 295 296 297 298 299 300 301 302 303 304 305 306 307 308 309 310 311 312 313 314 315 316 317 318 319 320 321 322 323 324 325 326 327 328 329 330 331 332 333 334 335 336 337 338 339 340 341 342 343 344 345 346 347 348 349 350 351 352 353 354 355 356 357 358 359 360 361 362 363 364 365 366 367 368 369 370 371 372 373 374 375 376 377 378 379 380 381 382 383 384 385 386 387 388 389 390 391 392 393 394 395 396 397 398 399 400 401 402 403 404 405 406 407 408 409 410 411 412 413 414 415 416 417 418 419 420 421 422 423 424 425 426 427 428 429 430 431 432 433 434 435 436 437 438 439 440 441 442 443 444 445 446 447 448 449 450 451 452 453 454 455 456 457 458 459 460 461 462 463 464 465 466 467 468 469 470 471 472 473 474 475 476 477 478 479 480 481 482 483 484 485 486 487 488 489 490 491 492 493 494 495 496 497 498 499 500 501 502 503 504 505 506 507 508 509 510 511 512 513 514 515 516 517 518 519 520 521 522 523 524 525 526 527 528 529 530 531 532 533 534 535 536 537 538 539 540 541 542 543 544 545 546 547 548 549 550 551 552 553 554 555 556 557 558 559 560 561 562 563 564 565 566 567 568 569 570 571 572 573 574 575 576 577 578 579 580 581 582 583 584 585 586 587 588 589 590 591 592 593 594 595 596 597 598 599 600 601 602 603 604 605 606 607 608 609 610 611 612 613 614 615 616 617 618 619 620 621 622 623 624 625 626 627 628 629 630 631 632 633 634 635 636 637 638 639 640 641 642 643 644 645 646 647 648 649 650 651 652 653 654 655 656 657 658 659 660 661 662 663 664 665 666 667 668 669 670 671 672 673 674 675 676 677 678 679 680 681 682 683 684 685 686 687 688 689 690 691 692 693 694 695 696 697 698 699 700 701 702 703 704 705 706 707 708 709 710 711 712 713 714 715 716 717 718 719 720 721 722 723 724 725 726 727 728 729 730 731 732 733 734 735 736 737 738 739 740 741 742 743 744 745 746 747 748 749 750 751 752 753 754 755 756 757 758 759 760 761 762 763 764 765 766 767 768 769 770 771 772 773 774 775 776 777 778 779 780 781 782 783 784 785 786 787 788 789 790 791 792 793 794 795 796 797 798 799 800 801 802 803 804 805 806 807 808 809 810 811 812 813 814 815 816 817 818 819 820 821 822 823 824 825 826 827 828 829 830 831 832 833 834 835 836 837 838 839 840 841 842 843 844 845 846 847 848 849 850 851 852 853 854 855 856 857 858 859 860 861 862 863 864 865 866 867 868 869 870 871 872 873 874 875 876 877 878 879 880 881 882 883 884 885 886 887 888 889 890 891 892 893 894 895 896 897 898 899 900 901 902 903 904 905 906 907 908 909 910 911 912 913 914 915 916 917 918 919 920 921 922 923 924 925 926 927 928 929 930 931 932 933 934 935 936 937 938 939 940 941 942 943 944 945 946 947 948 949 950 951 952 953 954 955 956 957 958 959 960 961 962 963 964 965 966 967 968 969 970 971 972 973 974 975 976 977 978 979 980 981 982 983 984 985 986 987 988 989 990 991 992 993 994 995 996 997 998 999 1000		
14 15 16	28 29 30		46 47 48			64 65 66	82 83 84
17 18	31 32 33		49 50 51			67 68 69	85 86 87
19	34 35 36	52 53 54	70 71 72	88 89 90			
20	37 38 39	55 56 57	73 74 75	91 92 93			
21	40 41 42	58 59 60	76 77 78	94 95 96			
22	43 44 45	61 62 63	79 80 81	97 98 99			
23	46 47 48	64 65 66	82 83 84	100 101 102			
24	49 50 51	67 68 69	85 86 87	103 104 105			
25	52 53 54	70 71 72	88 89 90	106 107 108			
26	55 56 57	73 74 75	91 92 93	109 110 111			
27	58 59 60	76 77 78	94 95 96	112 113 114			
28	61 62 63	79 80 81	97 98 99	115 116 117			
29	64 65 66	82 83 84	100 101 102	118 119 120			
30	67 68 69	85 86 87	103 104 105	121 122 123			
31	70 71 72	88 89 90	106 107 108	124 125 126			
32	73 74 75	91 92 93	109 110 111	127 128 129			
33	76 77 78	94 95 96	112 113 114	130 131 132			
34	79 80 81	97 98 99	115 116 117	133 134 135			
35	82 83 84	100 101 102	118 119 120	136 137 138			
36	85 86 87	103 104 105	121 122 123	139 140 141			
37	88 89 90	106 107 108	124 125 126	142 143 144			
38	91 92 93	109 110 111	127 128 129	145 146 147			
39	94 95 96	112 113 114	130 131 132	148 149 150			
40	97 98 99	115 116 117	133 134 135	151 152 153			
41	100 101 102	118 119 120	136 137 138	154 155 156			
42	103 104 105	121 122 123	139 140 141	157 158 159			
43	106 107 108	124 125 126	142 143 144	160 161 162			
44	109 110 111	127 128 129	145 146 147	163 164 165			
45	112 113 114	130 131 132	148 149 150	166 167 168			
46	115 116 117	133 134 135	151 152 153	169 170 171			
47	118 119 120	136 137 138	154 155 156	172 173 174			
48	121 122 123	139 140 141	157 158 159	175 176 177			
49	124 125 126	142 143 144	160 161 162	178 179 180			
50	127 128 129	145 146 147	163 164 165	181 182 183			
51	130 131 132	148 149 150	166 167 168	184 185 186			
52	133 134 135	151 152 153	169 170 171	187 188 189			
53	136 137 138	154 155 156	172 173 174	190 191 192			
54	139 140 141	157 158 159	175 176 177	193 194 195			
55	142 143 144	160 161 162	178 179 180	196 197 198			
56	145 146 147	163 164 165	181 182 183	199 200 201			
57	148 149 150	166 167 168	184 185 186	202 203 204			
58	151 152 153	169 170 171	187 188 189	205 206 207			
59	154 155 156	172 173 174	190 191 192	208 209 210			
60	157 158 159	175 176 177	193 194 195	211 212 213			
61	160 161 162	178 179 180	196 197 198	214 215 216			
62	163 164 165	181 182 183	199 200 201	217 218 219			
63	166 167 168	184 185 186	202 203 204	220 221 222			
64	169 170 171	187 188 189	205 206 207	223 224 225			
65	172 173 174	190 191 192	208 209 210	226 227 228			
66	175 176 177	193 194 195	211 212 213	229 230 231			
67	178 179 180	196 197 198	214 215 216	232 233 234			
68	181 182 183	199 200 201	217 218 219	235 236 237			
69	184 185 186	202 203 204	220 221 222	238 239 240			
70	187 188 189	205 206 207	223 224 225	241 242 243			
71	190 191 192	208 209 210	226 227 228	244 245 246			
72	193 194 195	211 212 213	229 230 231	247 248 249			
73	196 197 198	214 215 216	232 233 234	250 251 252			
74	199 200 201	217 218 219	235 236 237	253 254 255			
75	202 203 204	220 221 222	238 239 240	256 257 258			
76	205 206 207	223 224 225	241 242 243	259 260 261			
77	208 209 210	226 227 228	244 245 246	262 263 264			
78	211 212 213	229 230 231	247 248 249	265 266 267			
79	214 215 216	232 233 234	250 251 252	268 269 270			
80	217 218 219	235 236 237	253 254 255	271 272 273			
81	220 221 222	238 239 240	256 257 258	274 275 276			
82	223 224 225	241 242 243	259 260 261	277 278 279			
83	226 227 228	244 245 246	262 263 264	280 281 282			
84	229 230 231	247 248 249	265 266 267	283 284 285			
85	232 233 234	250 251 252	268 269 270	286 287 288			
86	235 236 237	253 254 255	271 272 273	289 290 291			
87	238 239 240	256 257 258	274 275 276	292 293 294			
88	241 242 243	259 260 261	277 278 279	295 296 297			
89	244 245 246	262 263 264	280 281 282	298 299 300			
90	247 248 249	265 266 267	283 284 285	301 302 303			
91	250 251 252	268 269 270	286 287 288	304 305 306			
92	253 254 255	271 272 273	289 290 291	307 308 309			
93	256 257 258	274 275 276	292 293 294	310 311 312			
94	259 260 261	277 278 279	295 296 297	313 314 315			
95	262 263 264	280 281 282	298 299 300	316 317 318			
96	265 266 267	283 284 285	301 302 303	319 320 321			
97	268 269 270	286 287 288	304 305 306	322 323 324			
98	271 272 273	289 290 291	307 308 309	325 326 327			
99	274 275 276	292 293 294	310 311 312	328 329 330			
100	277 278 279	295 296 297	313 314 315	331 332 333			
101	280 281 282</						

GTX-17 Technical Specifications

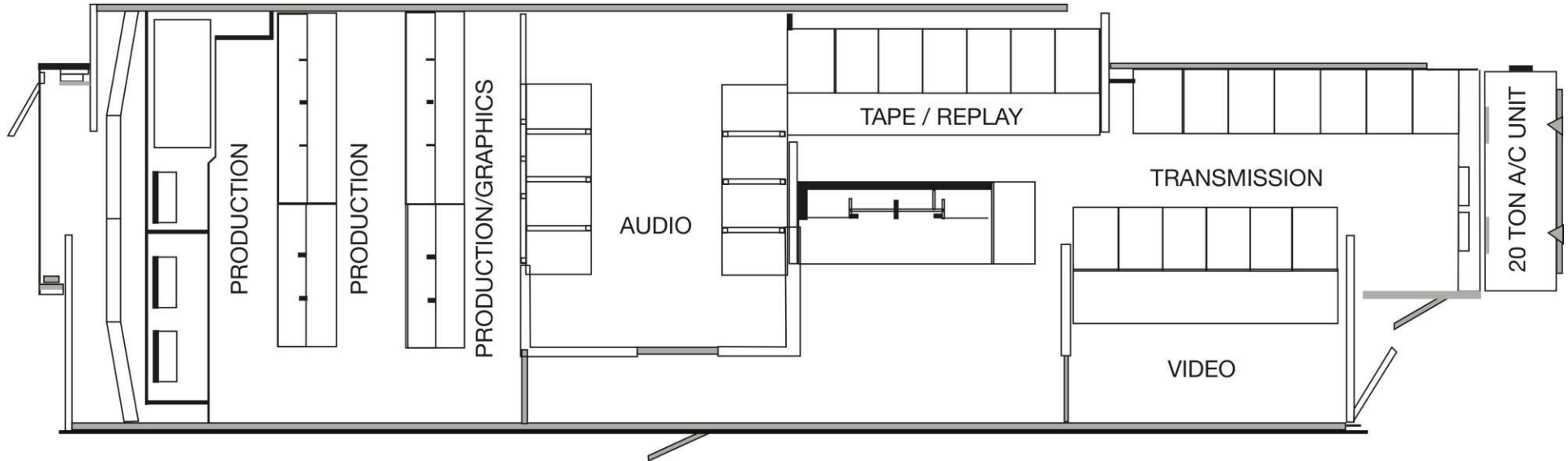

F&F PRODUCTIONS, LLC

14333 Myerlake Circle | Clearwater, FL 33760 | (727) 530-5000 | info@fandfhd.tv